

92-S-62 - SPEEDLINE System Data Sheet - Version V1 (24-10-23)

SPEEDLINE 92mm 'C' Stud Partition @600mm Ctrs,
with 2x Siniat GTEC 15mm Fire Board each side

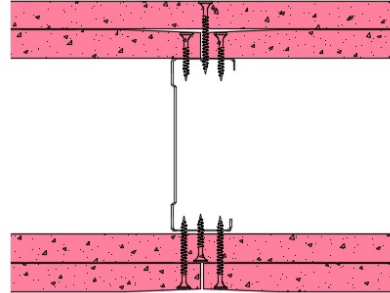

System Performance Breakdown

Fire Resistance:

BS476 Part 22:1987:

Test Ref & Date or Applied Ref & Report:

Max Height:

Thickness:

Duty Grade: BS 5234: Part 2:1992:

Sound Insulation:

120/120 Minutes (Integrity/Insulation).

BTC 17593FA - BRE Report P102396-1011C

Refer to Speedline Specification Clause

154 mm. (At Base Track, Excluding Finishes)

Severe - Annexes A-F

50 R_w dB, Date Tested or Assessed Against - 70-S-62

Test Code:
H19646AA
Test Date:
07/07/2016

Freq. Hz	R dB
50	23.2
63	13.8
80	16.0
100	25.1
125	27.1
160	35.9
200	43.5
250	46.7
315	45.4
400	50.0
500	53.6
630	54.8
800	58.3
1 000	59.6
1 250	60.7
1 600	58.8
2 000	48.3
2 500	48.0
3 150	51.9
4 000	54.0
5 000	57.8

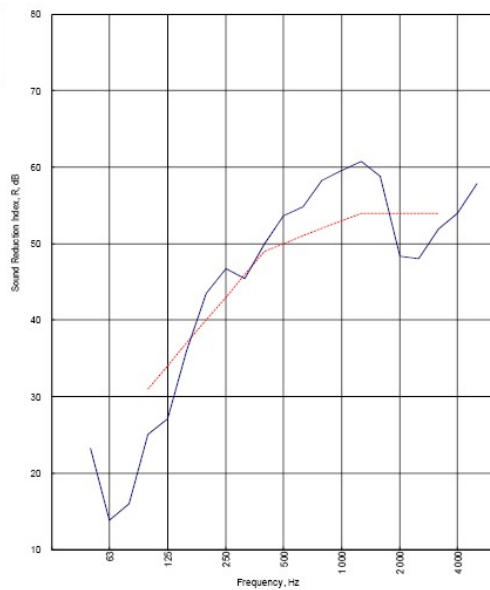

Rating according to BS EN ISO 717-1:2013
 R_w (C;Ctr) = 50 (-2;-8) dB
 Max dev. 6.9 dB at 125 Hz

$C_{50-3150}$ = -6 dB	$C_{50-8000}$ = -5 dB	$C_{100-6300}$ = -2 dB
$C_{tr,50-3150}$ = -17 dB	$C_{tr,50-8000}$ = -17 dB	$C_{tr,100-6300}$ = -8 dB

TESTED AT ONE OF THE UKAS ACCREDITED LABORATORIES BELOW

B.T.C (H-Ref on Graph)

B.R.E

AIRO

S.R.L

Customer: Voestalpine Metsec Plc Dry Lining

BTC 19646A: Page 9 of 12

